



120LM/W 50W CCT LED Batten

Products Description

The LED Linear Batten, a directly replace T5&T8 Batten. Available in a range of lengths and wattages. The output lumen is 115-125lm/w, 50,000 hours long life, and 90% uniformity across the emitting surface.

The Batten enables customers to recover initial investment quickly and greatly reduce the maintenance cost.

The LED Batten is ideal for EMC energy-saving projects in places of work and educational locations, healthcare and retail environments.

Parameters

| Optical Parameters | | | |
|-------------------------|--|---------|---------------|
| CCT | 6000K/5000K | 4000K | 3000K |
| Lumen Output(lm)±5% | 6200 | 6200 | 5700 |
| Lumen Efficacy(LPS)±5% | 125 | 125 | 115 |
| LED Type/Qt'y | Samsung 0.5W 2835 2x156pcs | | |
| CRI/SDCM | >80/<5 | | |
| Electrical Parameters | | | |
| Rated Power(w)±5% | 50 | | |
| Rated/Actual Input | 220~240Vac | 50/60Hz | |
| Driver Output Data | 38-40Vdc / 1100mA / 44W | | |
| Power Factor/THD/PE | >90%/<20/90% | | |
| Driver/Connection | Internal Driver / PIP | | |
| Over Load/Short Circuit | Protection | | |
| Surge/Protection Class | >1KV / Class I | | |
| IEC | | | |
| Hi-pot Test Range | Non Isolated Driver, 1500Vdc/5mA/60S | | |
| Life | | | |
| Warranty | 5 years | | |
| Lumen Maintenance 70% | 50,000hrs | | |
| LM80 | 97.1% lumen maintance @ 9,000hrs | | |
| Others | | | |
| Dimmable Solution | Dali/0~10V/PWM/Traic Optional | | |
| Frame Color | White body and end-cap,Ttranslucence PC diffuser | | |
| IP/IK/Glow-wire | IP20/IK07/850°C | | |
| Shatter proof | Yes | | |
| Temp./Humidity | Working:-20°C~50°C | | Storage:<60°C |
| Net/Gross Weight | 1.7kg /2.1kg | | |

Products Dimens

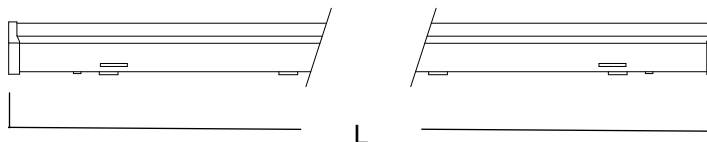
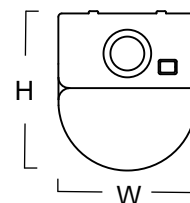

LED Batten: L=1470mm W=62mm H=72mm

Certification:

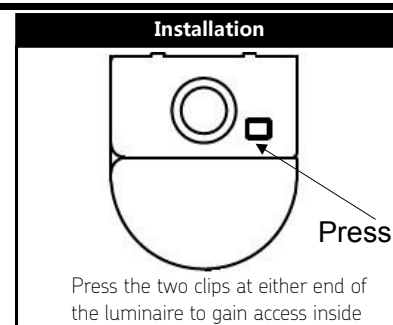
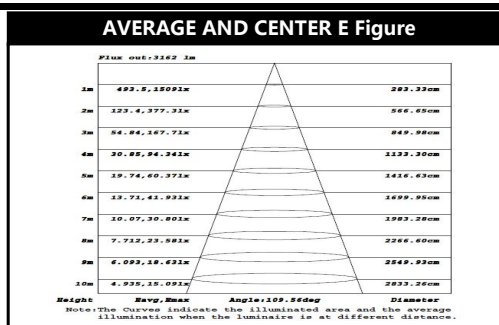
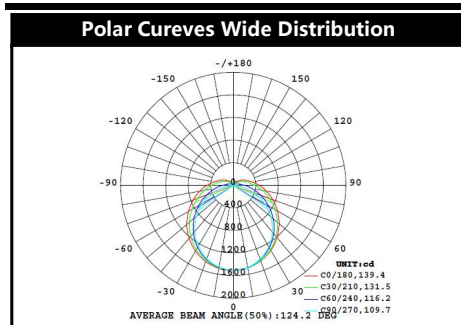

Quality LED Lighting