



85LM/W 60W LED Batten

Products Description

The Slimline LED Linear Battens, a directly replace T5&T8 Battens. Available in a range of lengths and wattages. The output lumen is 85-110lm/w, 50,000 hours long life, and 90% uniformity across the emitting surface.

The Batten enables customers to recover initial investment quickly and greatly reduce the maintenance cost.

The LED Batten is ideal for EMC energy-saving projects in places of work and educational locations, healthcare and retail environments.

Parameters

Optical Parameters			
CCT	6500K	4500K	3000K
Lumen Output(lm)±5%	6300	5700	5100
Lumen Efficacy(LPS)±5%	105	95	85
LED Type/Qt'y	San'an Chip/ 0.2W 2835 3 2 4 pcs		
CRI/SDCM	>80/3000K/6500K<6, 4500K<9		
Electrical Parameters			
Rated Power(w)±5%	60		
Rated/Actual Input	220~240Vac	50/60Hz	
Driver Output Data	70-80Vdc / 750mA / 60W		
Power Factor/THD/PE	>90%/<20/90%		
Driver	Internal Driver		
Over Load/Short Circuit	Protection		
Surge/Protection Class	>1KV / Class I		
IEC			
Hi-pot Test Range	Non Isolated Driver, 1500Vac/5mA/60S		
Life			
Warranty	3 years		
Lumen Maintenance	50,000hrs		
70%			
LM80	97.1% lumen maintance @ 9,000hrs		
Others			
Frame Color	White body and end-cap,Micky diffuser		
IP/IK/Glow-wire	IP20/IK08/850°C		
Temp./Humidity	Working:-20°C~50°C Storage:<60°C		
Net/Gross Weight	0.8kg /1.05kg		

Products Dimens

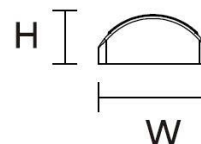

LED Batten: L=150mm W=38mm H=83mm

Certification:



Luminous Intensity Distribution

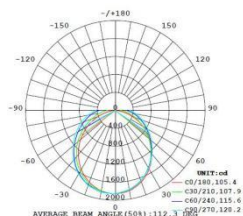

C0 Plane Isolux Diagram

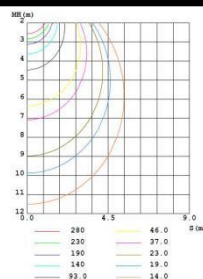

Installation

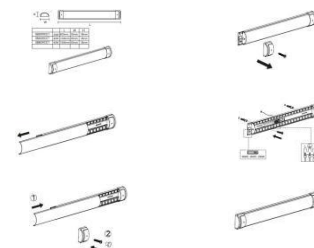

Quality LED Lighting